

Changing Wax Guards

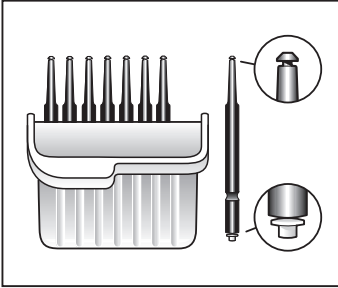

The wax guard tool has two functions:

- A removal tip to collect the used wax guard
- A replacement tip with a white wax guard

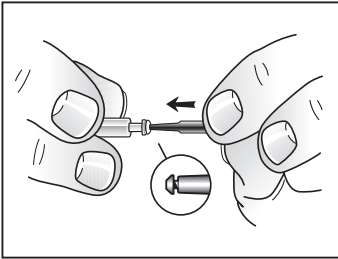

1. Insert the removal tip of the tool into the used wax guard so that the end of the tool touches the rim of the wax guard.

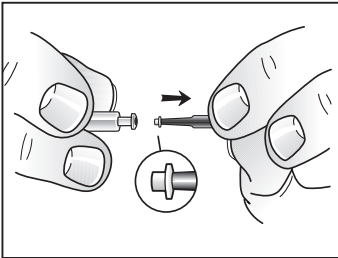

2. Slowly pull the wax guard straight out.

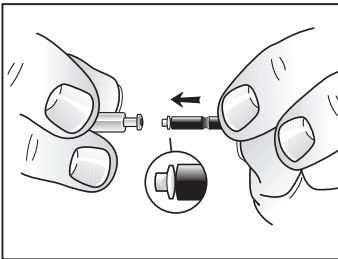

3. Turn the tool around and insert the replacement tip of the tool into the hole where you removed the old wax guard.

Changing wax guards (continued)

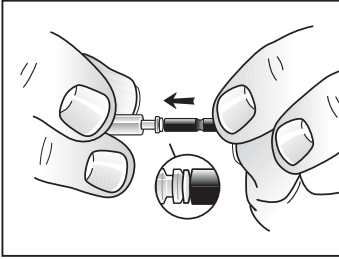

4. Gently press the replacement tip straight into the hole until it lies flush with the receiver end.

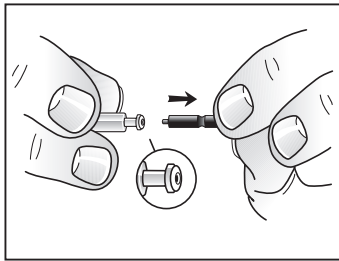

5. Pull the tool straight out. The replacement wax guard is now inserted into the receiver.

TOP TIP:

To ease removal and insertion, it may help to twist the wax guard tool.



For further support, scan the QR code or visit our patient support portal at: danalogic.co.uk/patient-portal