

# How to connect your danalogic Ambio hearing aids to the BeMore app on Apple® devices

1. Ensure your model of smart device is compatible by checking the following website: **[www.danalogic.co.uk/connectivity](http://www.danalogic.co.uk/connectivity)**
2. Go to 'Settings' and ensure Bluetooth® is turned on.
3. Go to the App Store and search 'BeMore for your hearing aids'.
4. If you are using an iPad, change the filters in the top left-hand corner to 'Supports iPad Only'.
5. Tap 'Get' to start downloading the app. Once the app has downloaded open it.
6. Click on 'Yes connect now' and scroll down to accept the Terms and Conditions of the app.
7. On the 'Updates' screen press 'Continue' and then 'Allow/Don't Allow' depending on your preference.
8. On the 'Bluetooth' screen click 'Allow' and then 'OK'.
9. Select your type of hearing aid and then follow the instructions on screen to connect your hearing aids.

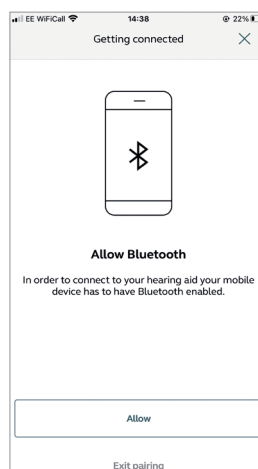

## How to connect your Ambio hearing aids to the BeMore app on Apple devices (continued)

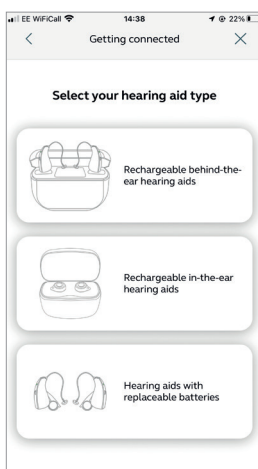
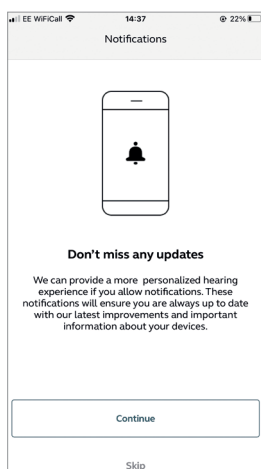
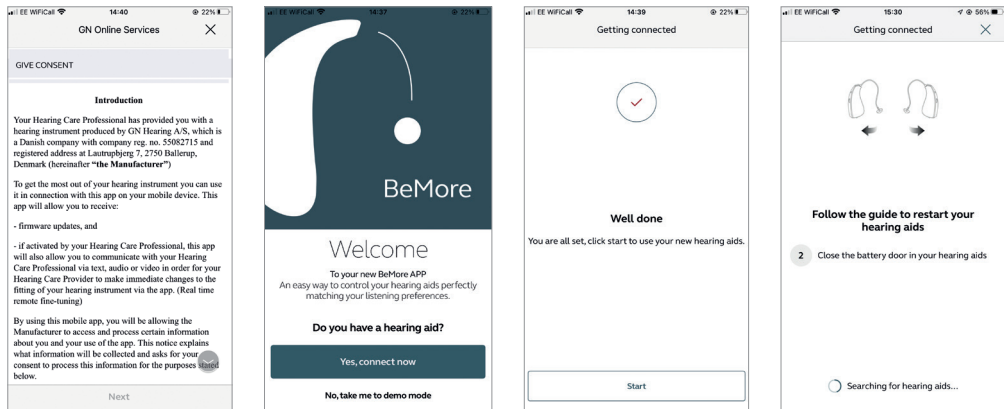

For further support, scan the QR code or visit our patient support portal at: [danalogic.co.uk/patient-portal](https://danalogic.co.uk/patient-portal)

The right choice for the NHS

danalogic GN